



PTFE-CON

Convolute PTFE Tubing

Product Description

Grayline PTFE-CON tubing is made from a semi-rigid, high temperature, fluoropolymer resin that offers outstanding chemical, electrical, and temperature resistance. The U.S. Food and Drug Administration sanctions all ingredients in this product for use in food contact applications. PTFE-CON has a spiral construction that allows easy cleaning and far greater flexibility than straight wall tubing. Optional wire coils provide increased pressure capability and aid in electrical grounding. For high vacuum applications, PTFE-CON can be produced with wire on the ID. The cuffs (straight ends) are made to accept standard barbed fittings.

Standard Packaging: Coils or Cut to Length
Standard Color: Natural (Translucent White)
Custom Services: Cut Length, Size, Overbraid

Specifications

- FDA Title 21 (Material Only)
- EU Directive 2011/65/EU (RoHS2)

Features

- Operating Temperature is -73°C to 260°C
- Excellent Chemical and Electrical Properties
- Low Coefficient of Friction
- Plasticizer-Free
- Excellent Flame Resistance
- Lead Free

PROPERTY	TYPICAL VALUE
Durometer Hardness, Shore D	50-65
Tensile Strength (psi)	3,500
Elongation (%)	200 - 400
Vacuum Service @ 72°F (in. Hg)	27
Brittleness Temperature (°C)	<-268
Maximum Operating Temperature (°C)	260

The values listed in this bulletin, to the best of our knowledge, are accurate. They are typical performance results and are not intended to be used as design data. We disclaim all liability in connection with the use of information contained herein or otherwise.



PTFE-CON

Convoluting PTFE Tubing

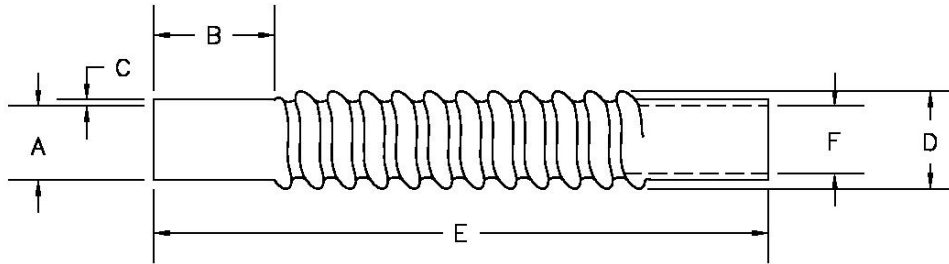

A = ID
B = Cuff Length
C = Wall Thickness
D = Convolution OD
E = Length
F = Convolution ID

PTFE-CON Without Wire

"A" ID (IN.)	"B" Cuff Length (IN.)	"C" Wall Thickness (IN.)	"D" Reference (IN.)	"F" Nominal (IN.)	Bend Radius (IN.)	Max Length (FT.)	Working PSI @ 70°F	Burst PSI @ 70°F
1/4	3/4	.015	.320	.181	1/2	125	45	180
5/16	1	.020	.414	.273	3/4	125	48	192
3/8	1	.020	.450	.303	1-3/4	125	40	160
1/2	1	.020	.590	.425	1-1/4	100	30	120
5/8	1-1/4	.025	.660	.485	1-1/2	75	30	120
3/4	1-1/2	.025	.780	.608	1-3/4	75	25	100
1	2	.030	1.100	.849	2.230	50	22	90
1-1/4	2-1/2	.035	1.560	1.150	2-3/4	40	21	85
1-1/2	2-1/2	.040	1.910	1.410	3	40	20	80
2	2-1/2	.043	2.450	1.955	4-1/4	40	16	65

"E" dimension to be specified at time of order. All lengths will be supplied with "B" dimension cuffs.

PTFE-CON With Wire

"A" ID (IN.)	"B" Cuff Length (IN.)	"C" Wall Thickness (IN.)	"D" Reference (IN.)	"F" Nominal (IN.)	Bend Radius (IN.)	Max Length (FT.)	Working PSI @ 70°F	Burst PSI @ 70°F
1/4	3/4	.015	.320	.181	1/2	12	58	234
5/16	1	.020	.414	.273	3/4	12	62	250
3/8	1	.020	.450	.303	1-3/4	12	52	208
1/2	1	.020	.590	.425	1-1/4	20	39	156
3/4	1-1/2	.025	.780	.608	1-3/4	20	32	130
1	2	.030	1.100	.849	2-1/4	20	29	117

"E" dimension to be specified at time of order. All lengths will be supplied with "B" dimension cuffs.

The values listed in this bulletin, to the best of our knowledge, are accurate. They are typical performance results and are not intended to be used as design data. We disclaim all liability in connection with the use of information contained herein or otherwise.